

Body and ball  
Wing lever  
Ball seal  
Stem seal  
Medium and ambient temperature  
Operating pressure  
Thread

Nickel-plated brass  
Plastic  
PTFE  
NBR  
-10 °C to +80 °C  
max. 10 bar  
Female thread G (DIN EN ISO 228-1)  
Male thread R (ISO 7-1)

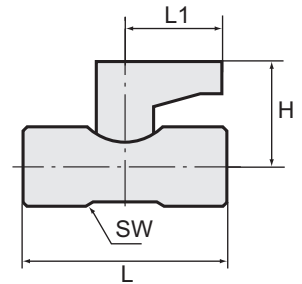

**Mini ball valves**

Art. No.	Ident No.	Thread	DN	a/f mm	L mm	L1 mm	H mm
371.101	103319	G 1/8 female	6	15	34.0	24.0	23.0
371.102	103320	G 1/4 female	6	15	38.0	24.0	23.0
371.103	103321	G 3/8 female	8	17	43.0	24.0	24.0
371.104	103322	G 1/2 female	10	21	49.0	24.0	27.0
371.201	103323	G 1/8 female / R 1/8 male	6	15	34.0	24.0	23.0
371.202	103324	G 1/4 female / R 1/4 male	6	15	39.0	24.0	23.0
371.203	103325	G 3/8 female / R 3/8 male	8	17	43.0	24.0	24.0
371.204	103326	G 1/2 female / R 1/2 male	10	21	50.0	24.0	27.0



371.102